

# Soda 110R

1:24 scale, fully 3D printed on FDM



More models at:

**[www.3drcmodels.com](http://www.3drcmodels.com)**

# Non printed parts

## Screws

**24x M1.2 x 5mm**

**63x M1.2 x 4mm**

**2x M1 x 4mm**



## Bearings

**6x 3x6x2**



*\* If you DONT want to build car as RC, you don't need any bearings*

## RC electronic *\* Optional if you want to have it as RC*



**2S ESC**

*\* No fancy ESC required.*



**6V DC Motor**

*\* cca 500 RPM*



**2S Lipo battery**

*\* Around 400mah is more than enough.*



**RC Set**

*\* Just basic RC set will do the job*

# Prologue

## Thank you

Thank you for supporting my hobby by buying this model. I had great time designing this kit and I hope you will have same building it and playing with it. Thanks small scale, it's very easy, cheap and quick to print and build.

More models can be found at  
[www.3drcmodels.com](http://www.3drcmodels.com)

## Warning!

Please be careful! Kit contain lots of small parts that can be swallow by infant. Event after build is finished, small parts can be ripped off and can be dangerous. I don't recommend giving this toy to kid younger 3 years.

# 1. Chassis



4x 3x6x2mm bearings and shaft has to fit tightly

1

2x



2x M1.2x4

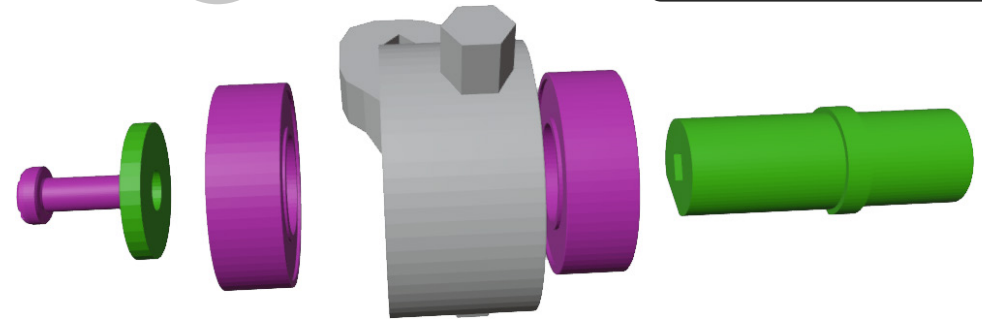

2

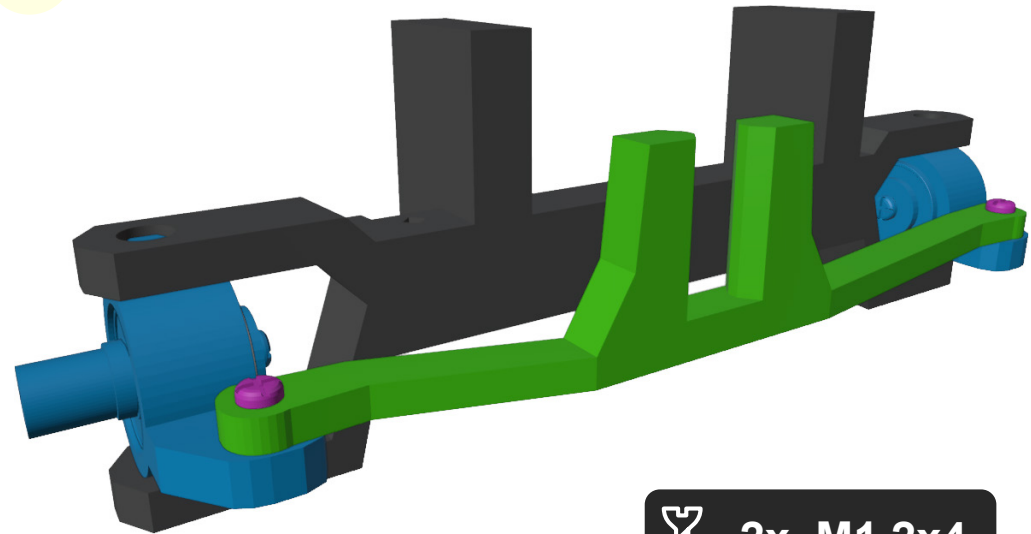

2x M1.2x4

3

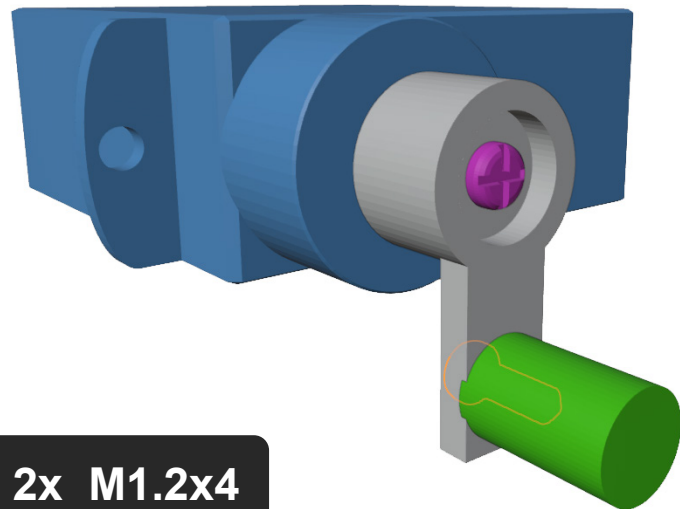

2x M1.2x4

5

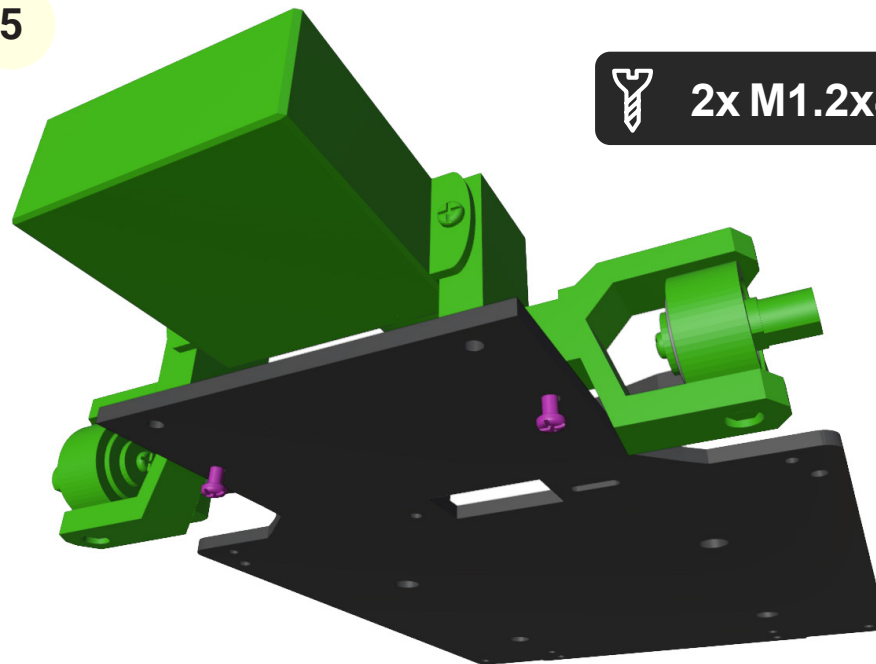

2x M1.2x4

4

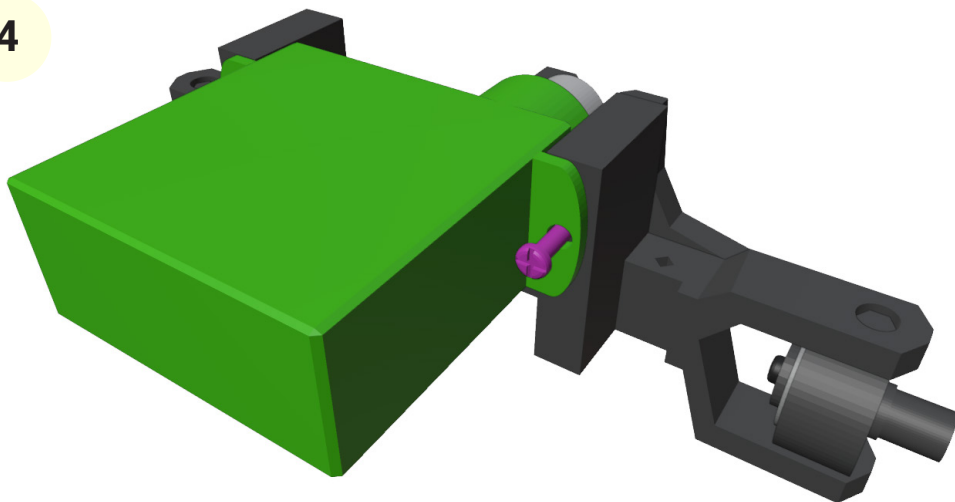

2x M1.2x4

6

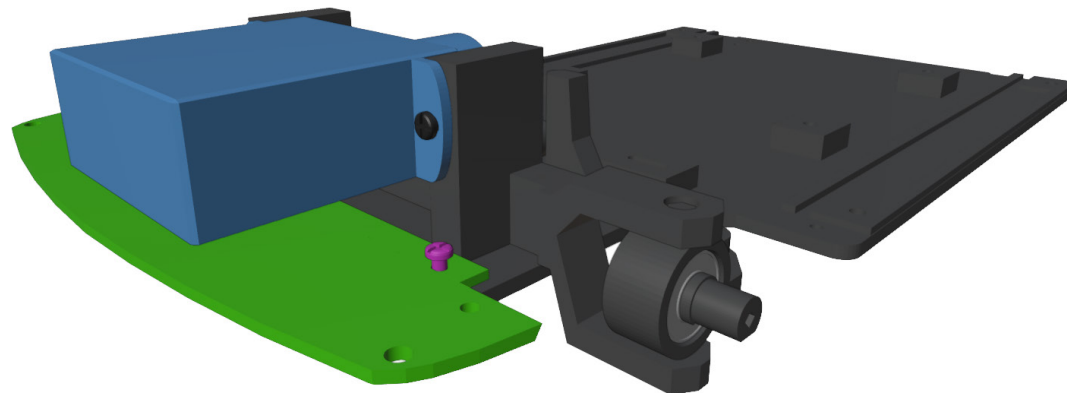

2x M1.2x4

7

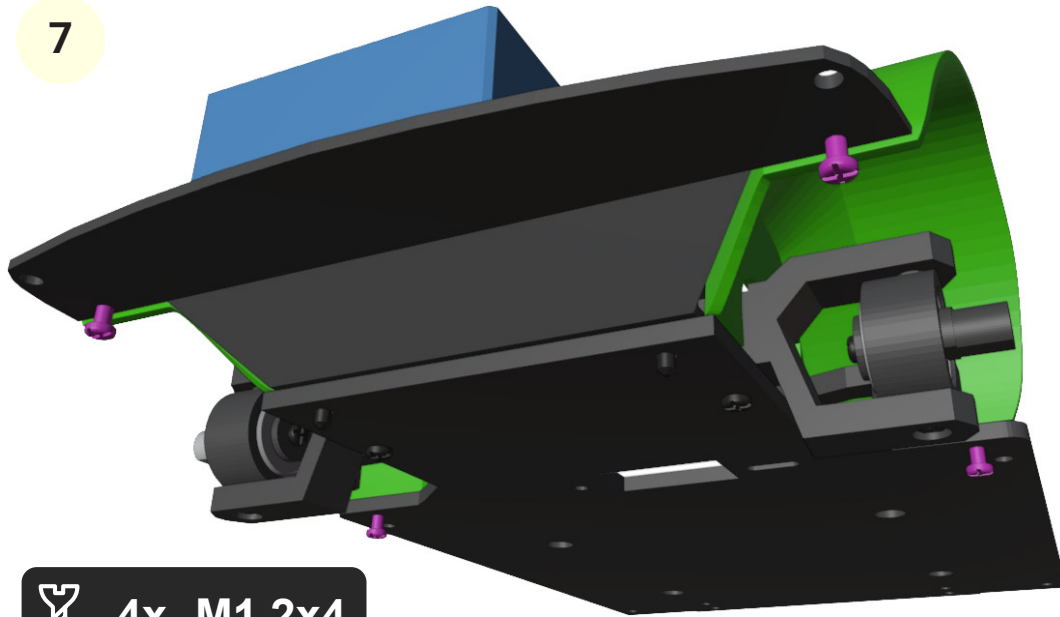

4x M1.2x4

8

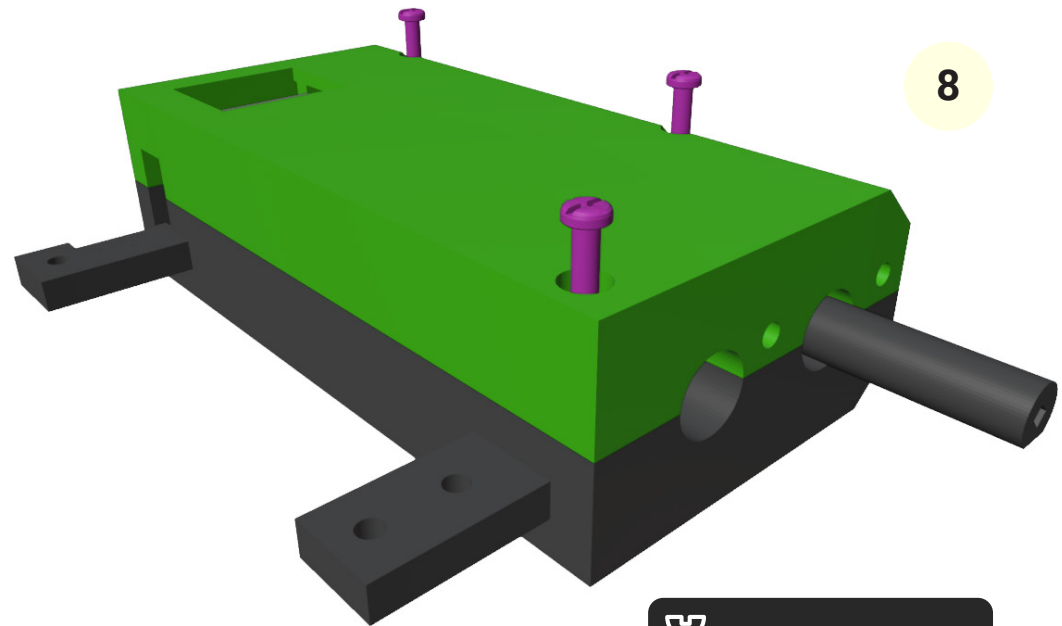

3x M1x4

8

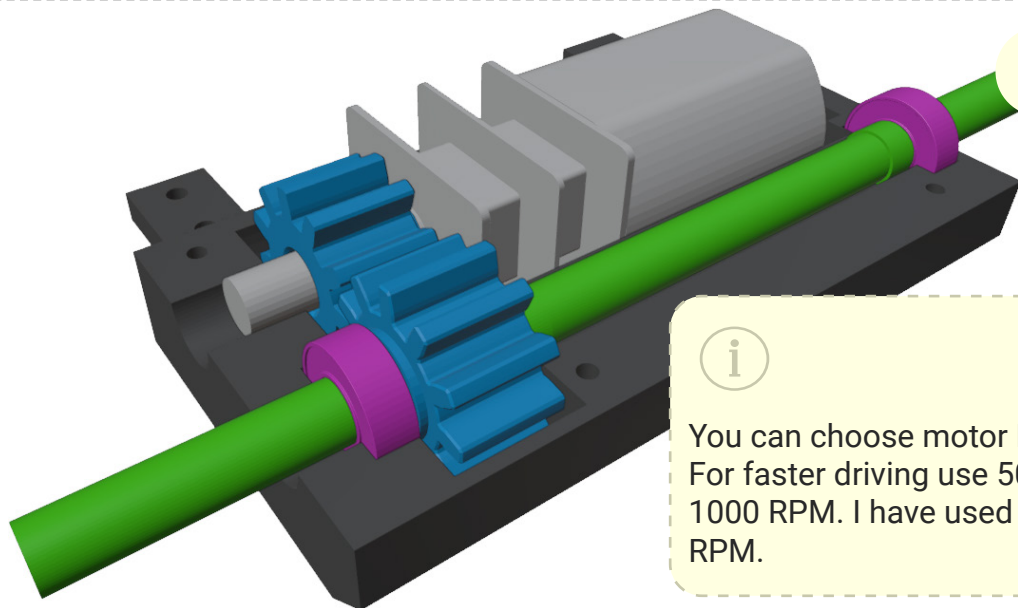

You can choose motor RPM.  
For faster driving use 500 -  
1000 RPM. I have used 1000  
RPM.



2x 3x6x2mm bearings and shaft has to fit tightly

9

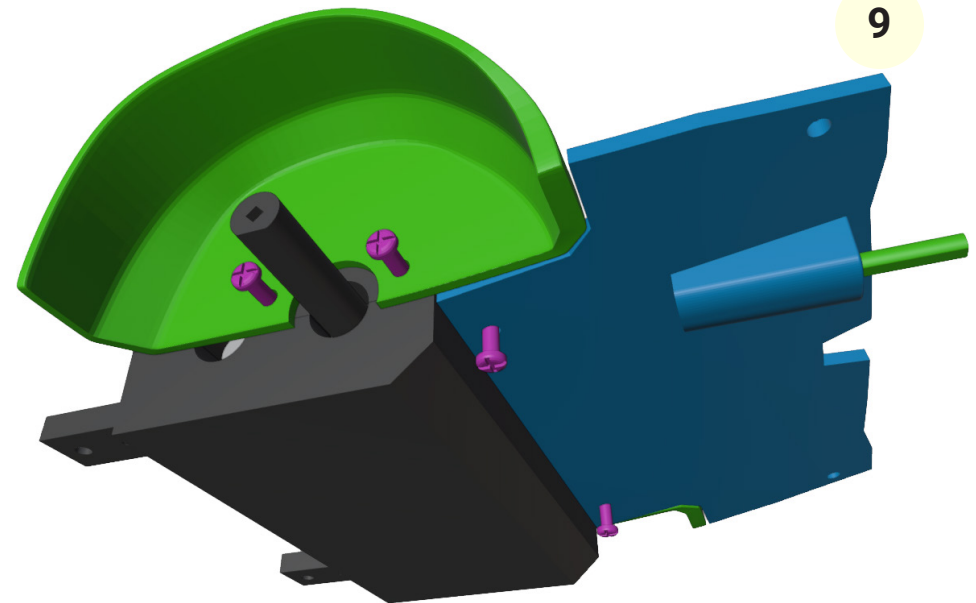

6x M1.2x4

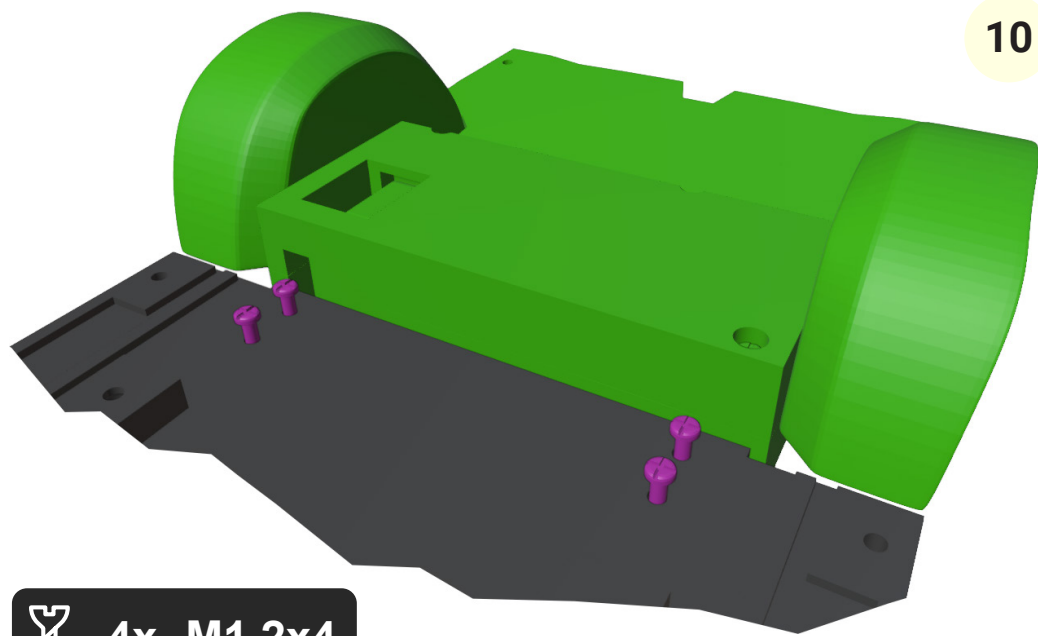

10

4x M1.2x4

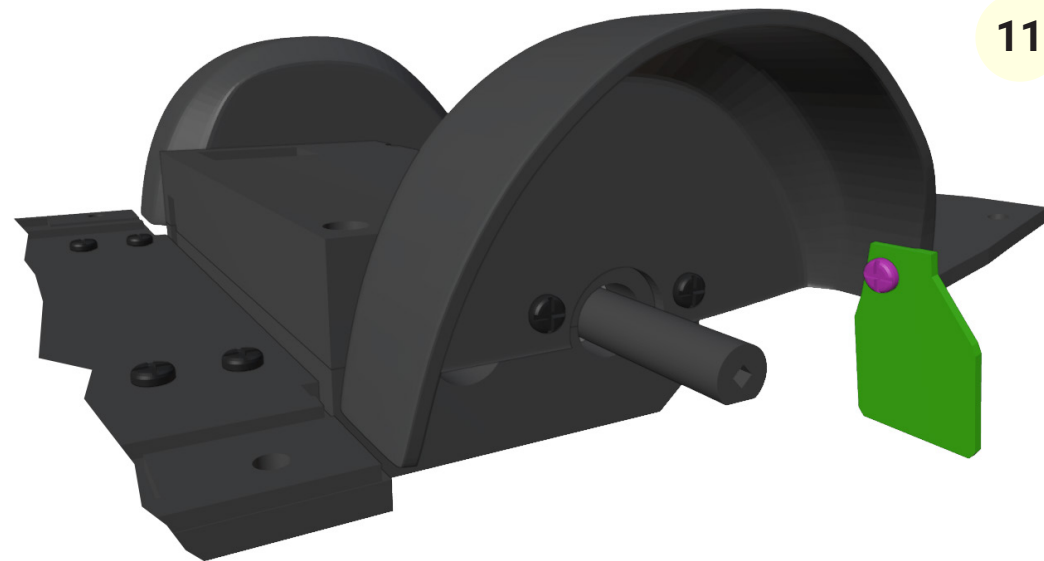

11

2x M1.2x3

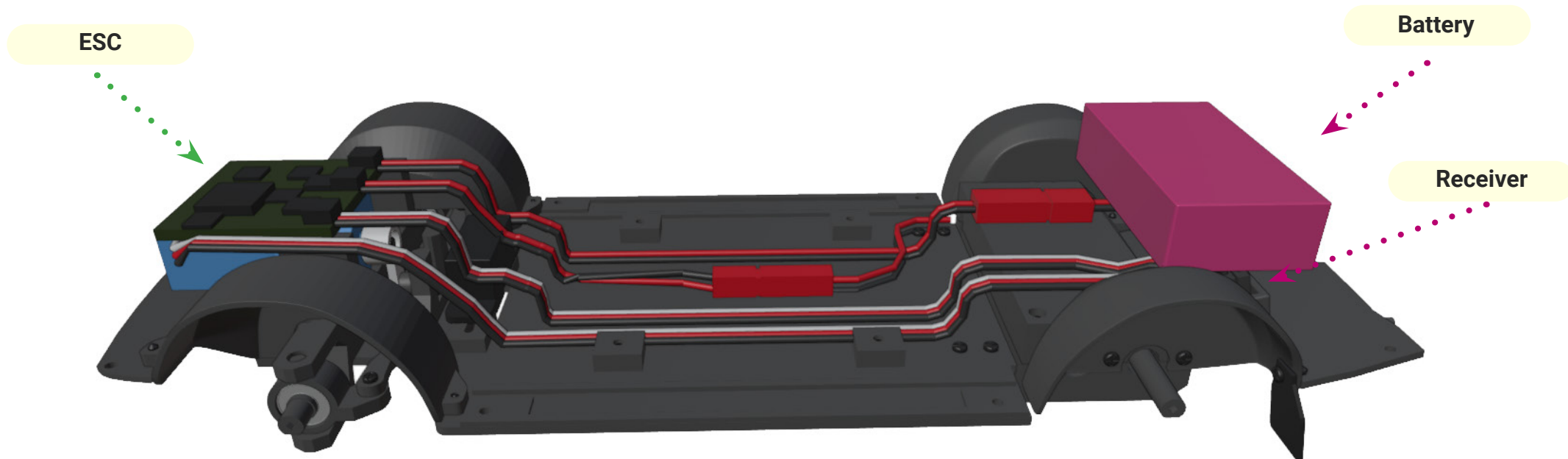

13



2x M1.2x4

15

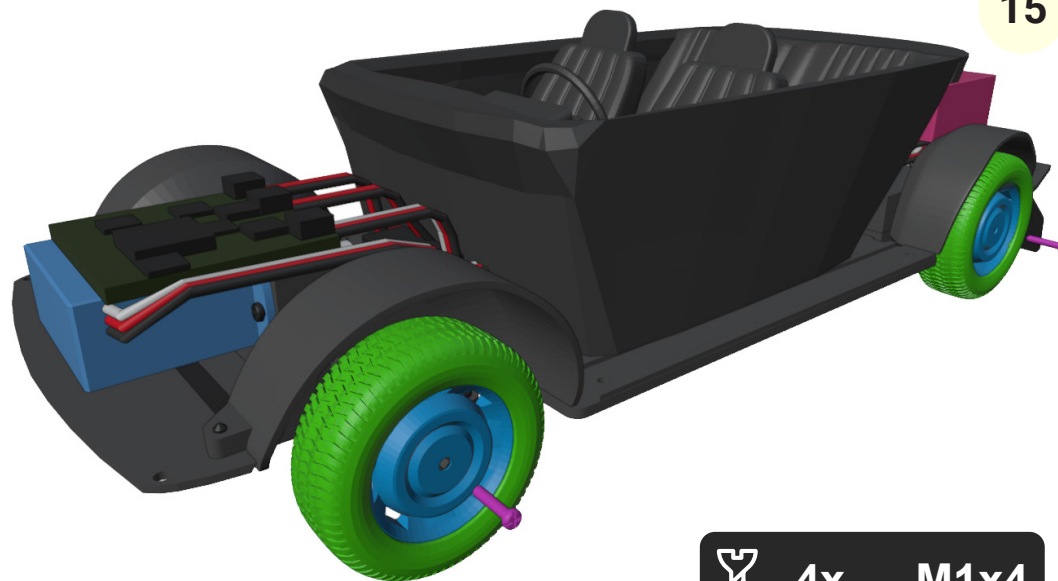

4x M1x4

14

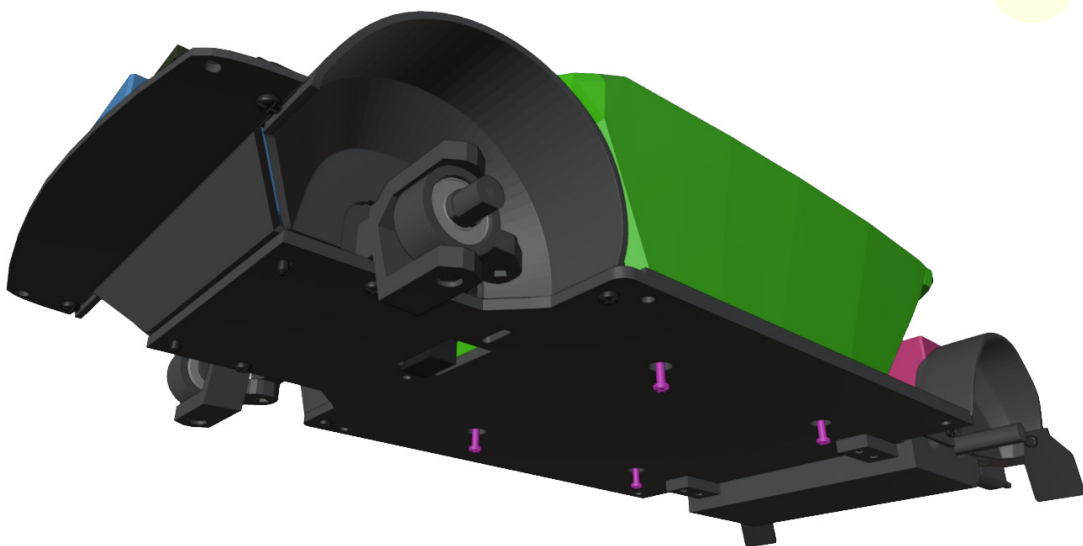

4x M1.2x4

16



**Well done!**

Chassis is finished!

## 2. Body

1

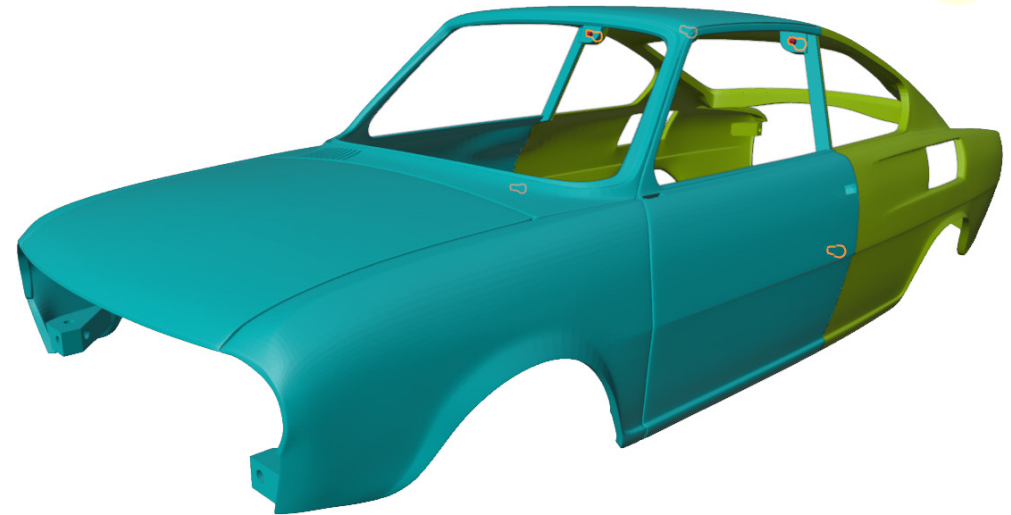

5x M1.2x4



2x M1.2x4

2

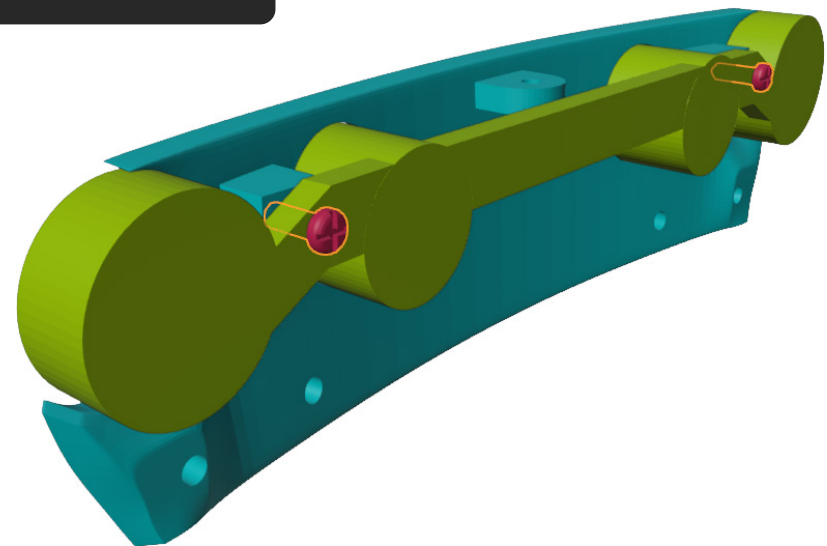



 3x M1.2x4



 2x M1.2x4

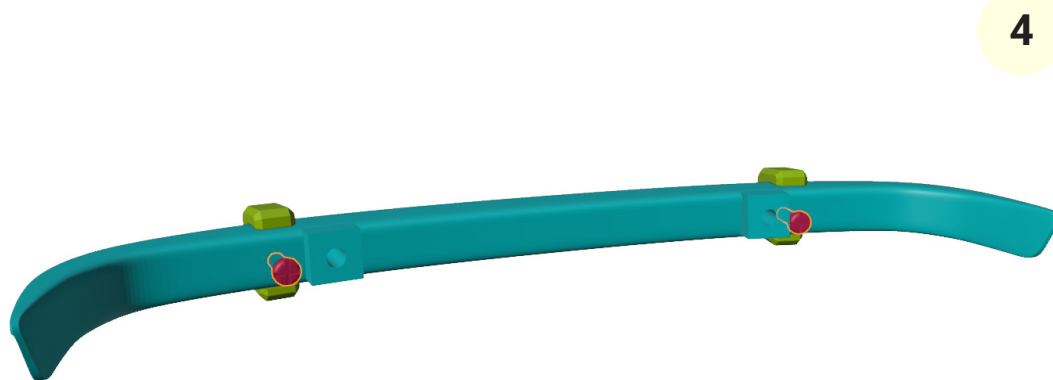

 2x M1.2x4

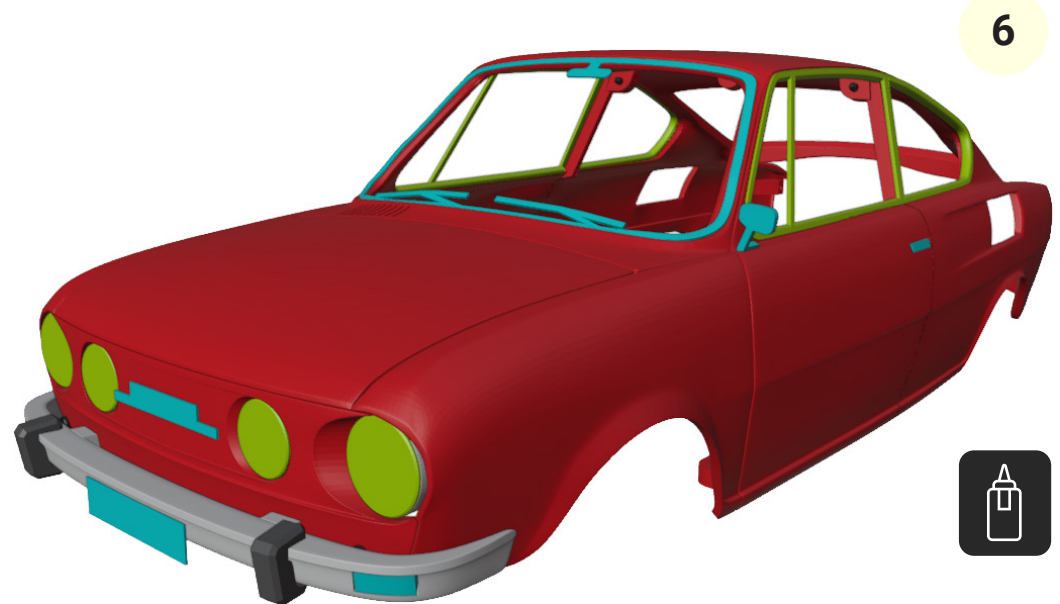

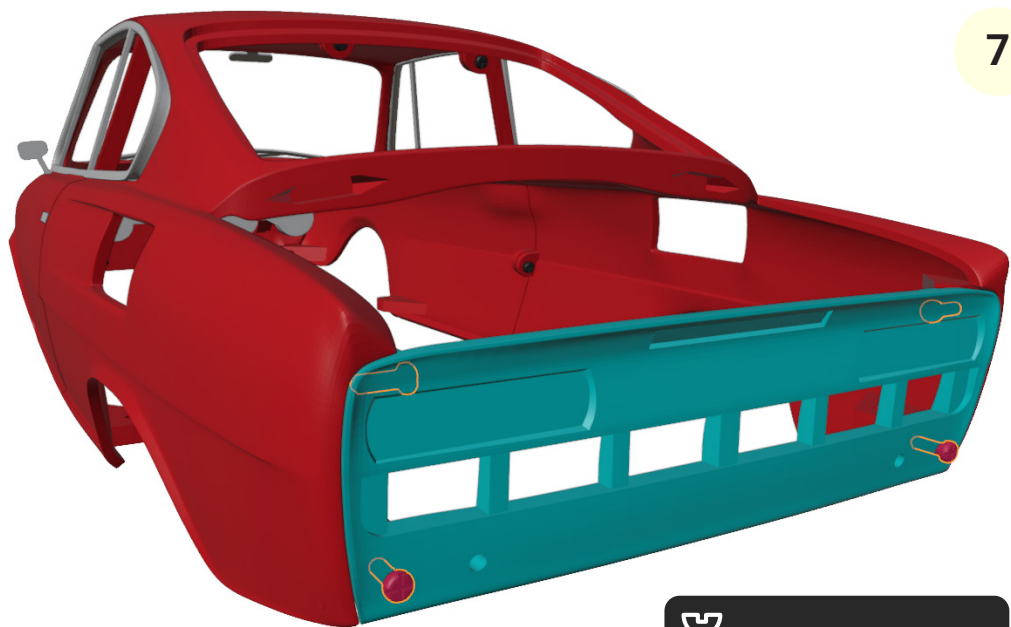

7



4x M1.2x4

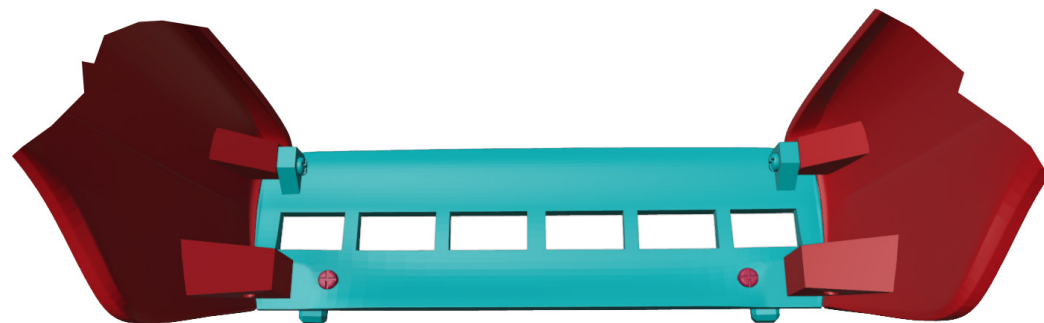

9



2x M1.2x4

8



2x M1.2x4

10

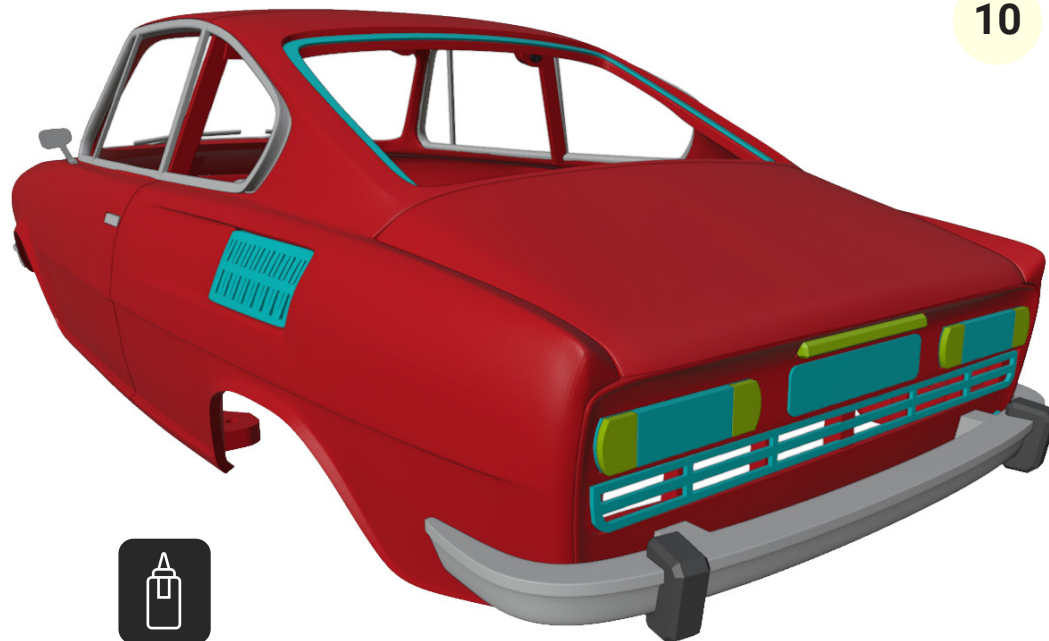

11



8x M1.2x4

12

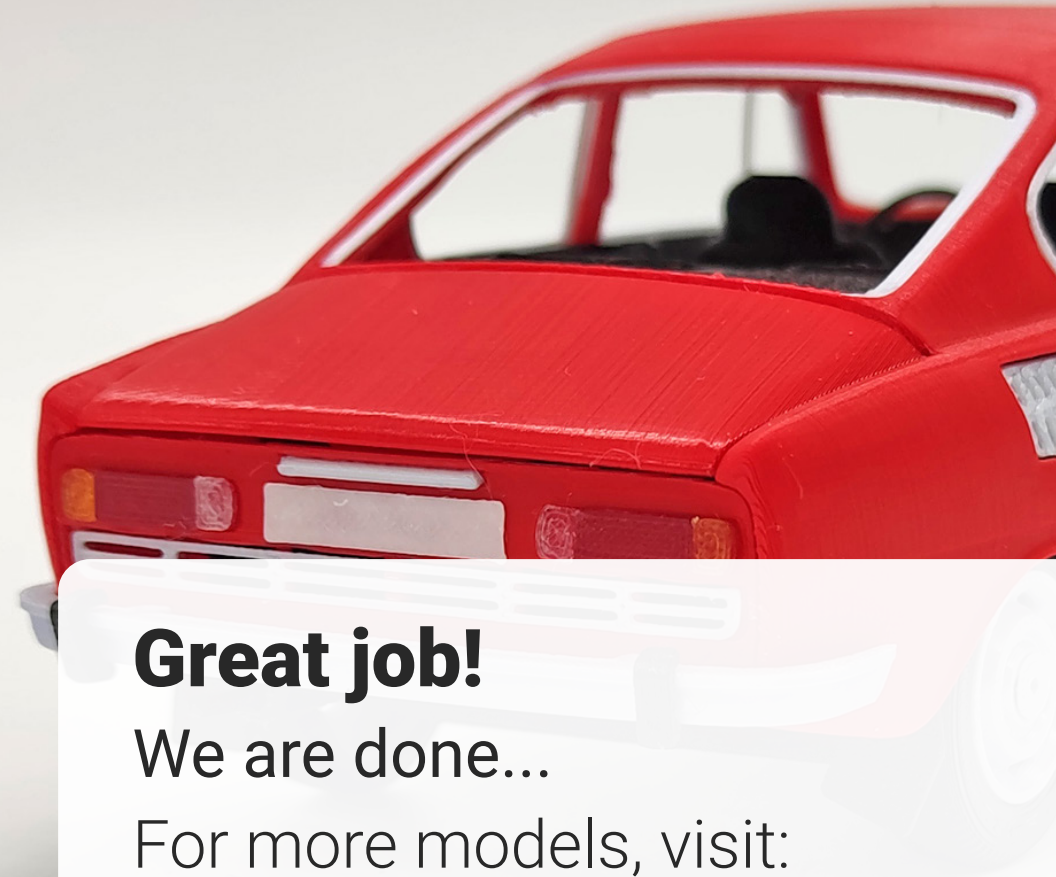

**Great job!**

We are done...

For more models, visit:

**[www.3drcmodels.com](http://www.3drcmodels.com)**